



Code	Botanical	Common	Plant Type	Height	Width	Sun	Water	Size	Quantity
ACH MIL	Achillea millefolium	Common Yarrow	Ground cover	2-3 ft.	2-3 ft.	Full, Half	Very Low	1 gal	3
AGA BLU	Agave 'Blue Flame'	Blue Flame Agave	Succulent	3-5 ft.	3-5 ft.	Full, Half	Low	1 gal	3
ANI BIG	Anigozanthos 'Big Red'	Big Red Kangaroo Paws	Perennial	4-6 ft.	2-3 ft.	Full	Medium, Extra in Summer	1 gal	4
CEA CON	Ceanothus 'Concha'	Concha California Lilac	Shrub	4-8 ft.	5-12 ft.	Full, Half	Low	1 gal	2
ECH FAS	Echium candicans	Pride Of Madeira	Shrub	6-8 ft.	8-10 ft.	Full, Half	Low	1 gal	2
GAU LIN	Gaura lindheimeri	White Gaura	Perennial	2-4 ft.	2 ft.	Full	Low, Extra in Summer	1 gal	4
GAU LIN	Gaura lindheimeri 'Siskiyou Pink'	Pink Gaura	Perennial	2-3 ft.	2-3 ft.	Full, Half	Very Low, Low	1 gal	2
HES PAR	Hesperaloe parviflora 'Yellow'	Yellow Yucca	Succulent	3-4 ft.	3-4 ft.	Full	Very Low, Extra in Summer	1 gal	2
LEO LEO	Leonotis leonurus	Lion's Tail	Shrub	4-6 ft.	4-6 ft.	Full	Very Low, Low, Extra in Summer	1 gal	3
LUP ALB	Lupinus albifrons	Silver Bush Lupine	Perennial	3-5 ft.	3-4 ft.	Full	Very Low	1 gal	3
SAL LEU	Salvia leucantha 'Santa Barbara'	Santa Barbara Sage	Shrub	3-4 ft.	3-4 ft.	Full, Half	Low	1 gal	2
DOU IRI	Iris douglasiana	Douglas Iris	Shrub	2-3 ft.	2-3 ft.	Full, Half	Low	1 gal	3



Ceanothus 'Concha'
Concha California Lilac



Echium candicans
Pride Of Madeira

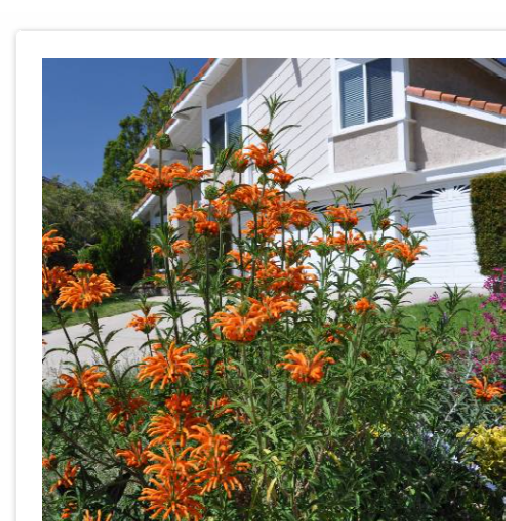

Leonotis leonurus
Lion's Tail



Salvia leucantha 'Santa Barbara'
Santa Barbara Sage

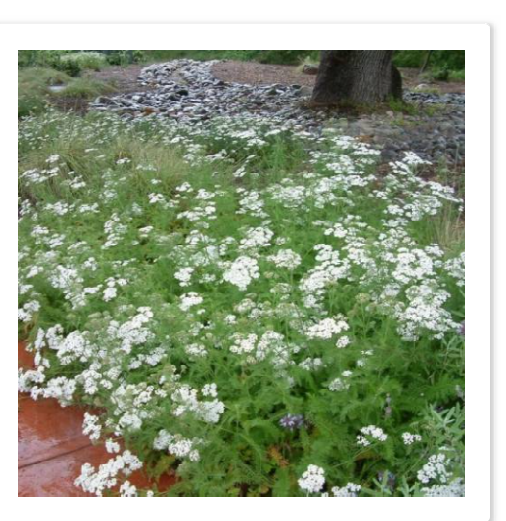

Achillea millefolium
Common Yarrow



Anigozanthos 'Big Red'
Big Red Kangaroo Paws



Gaura lindheimeri
White Gaura



Gaura lindheimeri 'Siskiyou Pink'
Pink Gaura

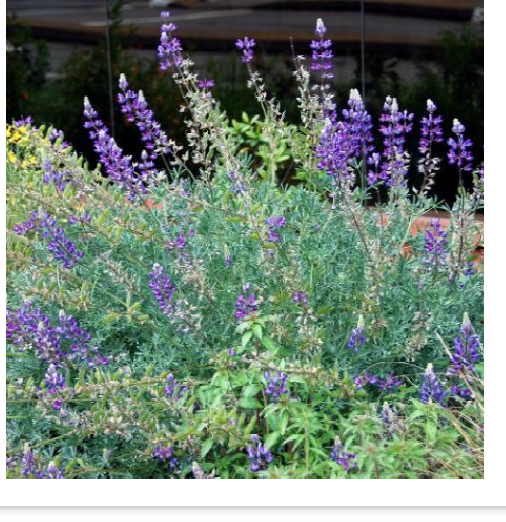

Lupinus albifrons
Silver Bush Lupine



Agave 'Blue Flame'
Blue Flame Agave

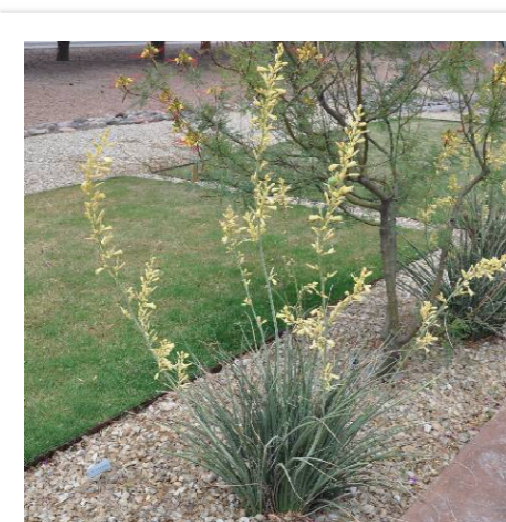

Hesperaloe parviflora 'Yellow'
Yellow Yucca

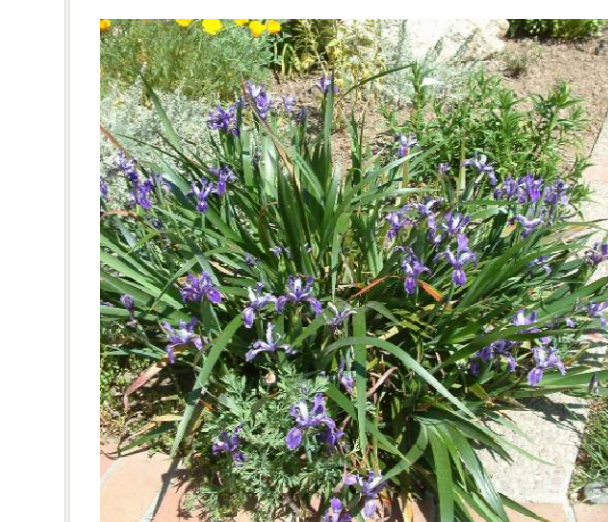

Iris douglasiana
Douglas Iris

EXISTING CONCRETE
STAIN EXISTING CONCRETE
COLOR - SANTA FE PFC-15

WEST COAST TURF
TALL FESCUE SOD

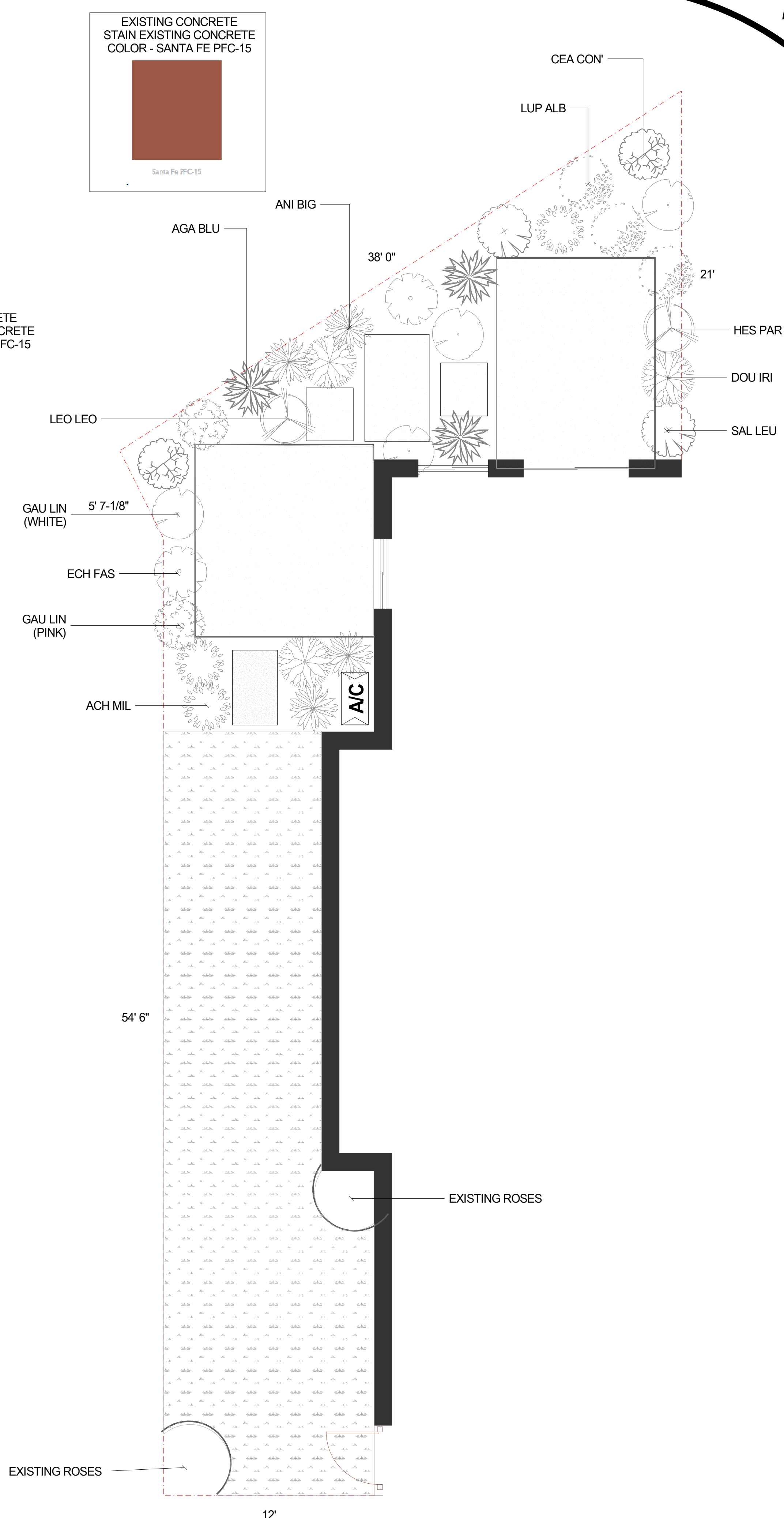

RECOMMENDED WATERING SCHEDULE

(LOW WATER PLANTING)

First 90 days 100% daily to establish plants, thereafter see schedule below for seasonal adjustments
Settings: Inland, Low Water Plants, Clay Loam, Drip-Emitter Line

Month	Jan	Feb	Mar	Apr	May	Jun	Jul*	Aug	Sep	Oct	Nov	Dec
Watering Days per Week	1	1	1	3	3	3	3	3	3	3	1	1
Minutes per Cycle	13	15	12	10	12	13	13	13	10	8	17	13
Cycles per Day	1	1	2	1	1	1	1	1	1	1	1	1

* If your irrigation controller has a "Seasonal Adjust %" or "budget Feature" I suggest that you program your controller to the July recommendations and then adjust as suggested below.

Inland - Seasonal Adjustments

Jan	Feb	Mar	Apr	May	Jun	Jul	Aug	Sep	Oct	Nov	Dec
30%	40%	60%	80%	90%	100%	100%	90%	80%	60%	40%	30%

Adjust your automatic timer, as best you can, according to the numbers you get from the calculator. You may need to make compromises based on the limitations of the controller. Pay attention to your plants for stress, and increase or decrease watering times accordingly. Skip two watering days when it rains or when the soil is already wet.